

SHIMANO NEXUS 3-SPEED HUB w/Hi-Power Roller Brake
SG-3R40-DX Inter-3 Hub **BR-IM31-R** Inter-M Brake

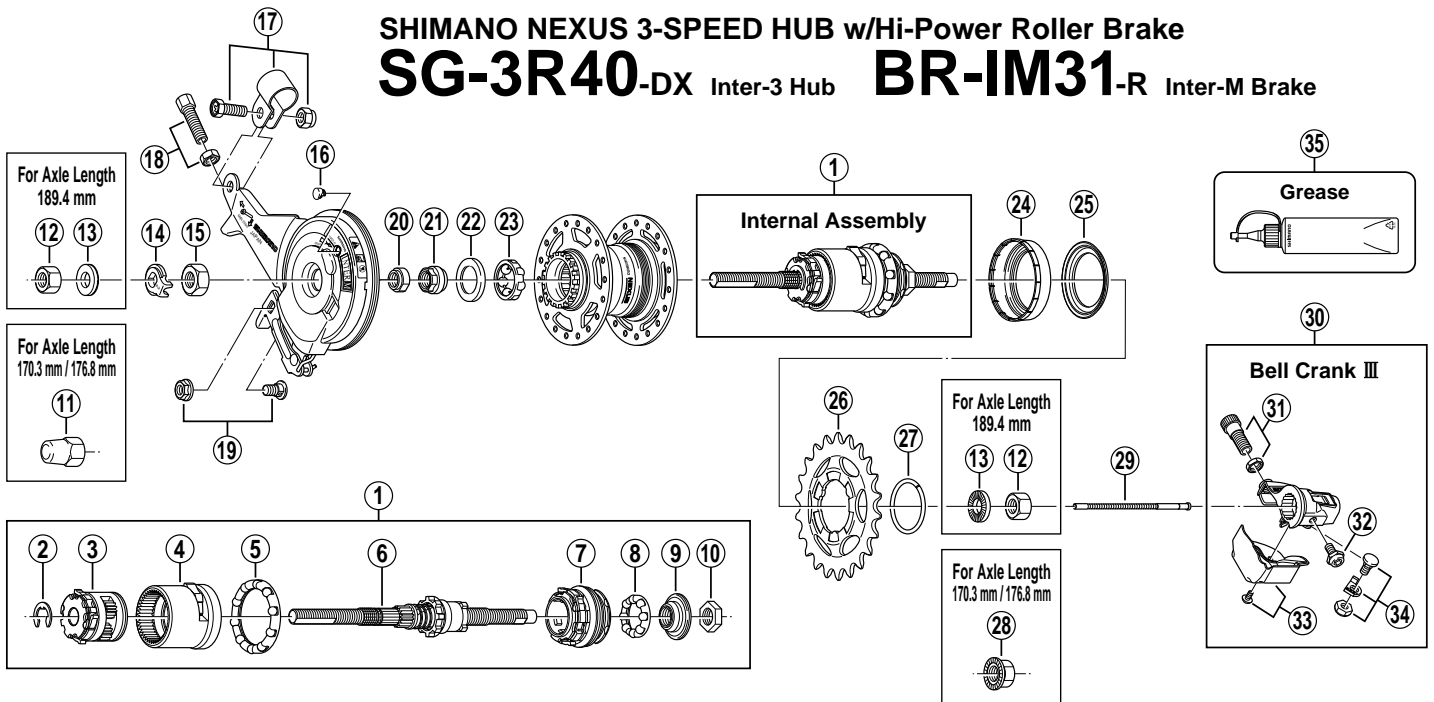

Q'TY	ITEM NO.	SHIMANO CODE NO.	DESCRIPTION
	1	Y-33S 90700	Internal Assembly (Axle Length 170.3 mm)
		Y-33S 98270	Internal Assembly (Axle Length 176.8 mm)
		Y-33S 90710	Internal Assembly (Axle Length 189.4 mm)
	2	Y-33Y 19000	Stop Ring (φ9.6 mm)
	3	Y-33S 90400	Carrier Unit
	4	Y-33S 90300	Ring Gear Unit
	5	Y-33R 90220	Ball Retainer K (7/32" x 10)
	6	Y-33S 98040	Axle Unit (Axle Length 170.3 mm)
		Y-33S 98280	Axle Unit (Axle Length 176.8 mm)
		Y-33S 98050	Axle Unit (Axle Length 189.4 mm)
	7	Y-33S 90200	Driver Unit
	8	Y-33R 90210	Ball Retainer J (7/32" x 8)
	9	Y-33R 90500	Right Hand Cone w/Dust Seal
	10	Y-33R 08100	Right Hand Lock Nut (5 mm) for Axle Length 170.3 mm / 189.4 mm
		Y-325 30100	Right Hand Lock Nut (9.9 mm) for Axle Length 176.8 mm
	11	Y-314 14010	Cap Nut (3/8") for Axle Length 170.3 mm / 176.8 mm
	12	Y-321 70020	Hub Nut (7 mm) for Axle Length 189.4 mm
		Y-200 03000	Hub Nut (9 mm) for Axle Length 189.4 mm
	13	Y-220 06000	Washer (2 mm) for Axle Length 189.4 mm
		Y-220 06040	Washer (3.2 mm) for Axle Length 189.4 mm
	14	Y-33Z 20200	Non-turn Washer 2 (Yellow)
	15	Y-75V 13000	Brake Unit Fixing Nut (8.2 mm) for Axle Length 170.3 mm / 189.4 mm
		Y-75V 13010	Brake Unit Fixing Nut (9.7 mm) for Axle Length 176.8 mm
	16	Y-75V 16010	Grease Hole Cap
		Y-75M 98050	Brake Arm Clip Unit (φ 15 mm)
		Y-33F 98090	Brake Arm Clip Unit (5/8")
		Y-75M 98060	Brake Arm Clip Unit (11/16")
	17	Y-33F 98100	Brake Arm Clip Unit (3/4")
		Y-75Y 98050	Brake Cable Adjusting Bolt & Nut
	19	Y-75Y 98060	Inner Cable Fixing Bolt & Nut
	20	Y-31Z 06020	Lock Nut for Left Hand Cone
	21	Y-33M 37000	Left Hand Cone
	22	Y-31Z 07000	Left Hand Dust Cap
	23	Y-321 90220	Ball Retainer A (1/4" x 7)
	24	Y-33R 05000	Right Hand Dust Cap A
	25	Y-33R 52001	Right Hand Dust Cap B
	26	Y-322 03220	Sprocket Wheel 16T (Silver)
		Y-322 03420	Sprocket Wheel 18T (Silver)
		Y-322 03520	Sprocket Wheel 19T (Silver)
		Y-322 03620	Sprocket Wheel 20T (Silver)
		Y-330 60000	Sprocket Wheel 21T (Silver)
		Y-330 60100	Sprocket Wheel 22T (Silver)
		Y-330 60200	Sprocket Wheel 23T (Silver)
	27	Y-321 20010	Snap Ring C
	28	Y-220 15010	Flange Nut for Axle Length 170.3 mm / 176.8 mm
		Y-33R 98080	Push Rod (81.85 mm) for Axle Length 170.3 mm
		Y-33S 98180	Push Rod (86.85 mm) for Axle Length 176.8 mm
	29	Y-33S 98290	Push Rod (90.75 mm) for Axle Length 189.4 mm
		Y-33S 95100	Bell Crank III Unit
	31	Y-33S 98010	Cable Adjusting Bolt & Nut
	32	Y-33S 57000	Bell Crank Body Fixing Bolt
	33	Y-33S 98020	Bell Crank Cover & Fixing Screw
	34	Y-33S 98030	Inner Cable Fixing Bolt Unit
	35	Y-041 20600	Internal Hub Grease (Net. 100g)
		Y-041 20400	Roller Brake Grease (Net. 100g)